



FumeBuster

What to specify...

1. Voltage

2. Pre-filter

3. Main filter





4. Capture Kit (For one or two stations)

1		Machine Only	
Voltage	230V ±10%	115V ±10%	
Vacuum Control	070362	070363	
Wattage	0.3 kW	0.3 kW	
Frequency	50Hz	60 Hz	
Cabinet height (inc castors)	350 mm	350 mm	
Cabinet width (not inc hose)	425 mm	425 mm	
Cabinet depth (not inc hose)	415 mm	415 mm	
Cabinet weight (inc filters)	25 Kg	25 Kg	
Construction	Precision engineered brushed stainless steel units. High performance continuous run brushless motors. Quick and simple to relocate.		

2		Pre-filter Pad	
	Options: F5 Pack of 4 (std) F8/F9 Pack of 4	Code: 200314 200098	

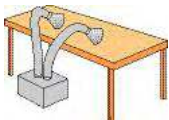
3		Main filter	
	Options: HEPA/Chemical (std) Chemical or Chemical Special HEPA/Chemical Cleanroom*	Code: 110531 110532 110542 110533	Solvent Lock 110541 * Use in combination with 200098

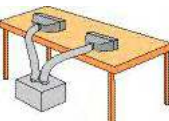

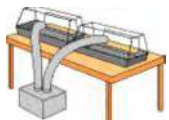
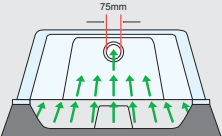
4		Capture Kit (Optional)	
	1 x 1.2m x 75mm Ø flexible arm with 2 x 75mm couplings (120707) + 1 x Conical cowl (840114) Code: 100181		
	1 x 1.5m x 75mm Ø flexible hose with 2 x 75mm couplings (100185) + 1 x Anti-static plenum cowl (black) (120702) Code: 100182		
	1 x 1.5m x 75mm Ø flexible hose with 2 x 75mm couplings (100185) + 1 x Cleancab extraction cabinet (840155) Code: 100183		

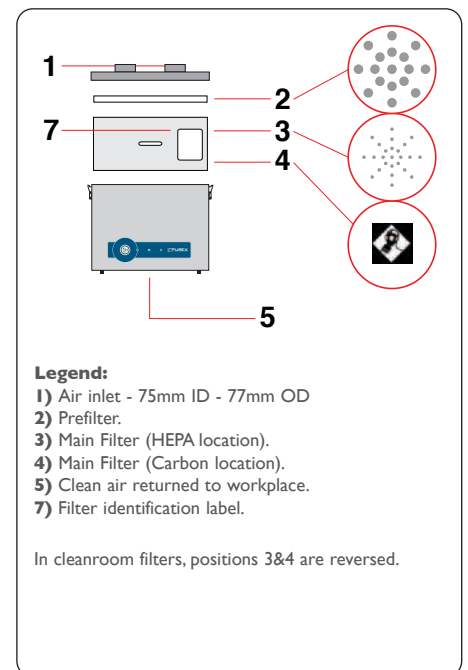

Controls

Visual and Audible Filter Blocked Warning

Alerts the operator when a filter is blocked so that a replacement filter can be acquired.

LED Filter Status

Green = Filter OK

Red = Filter full, replacement required

System Features...

- Audible and visual filter blocked alert
- Low capital and running costs
- Quick change pre-filters deliver longer filter life
- Submicronic (HEPA) filtration removes 99.997% of particles down to 0.3 microns
- Activated carbon filtration removes harmful gas
- Simple to install and quiet in operation
- Easy to relocate
- Precision made from stainless steel

Includes:

- 1 x Main filter
- 4 x Pre-filter pad
- 1 x Port blank (530430)
- 1 x Power cable

Accessories

Please see the accessories section at the back of this brochure.